

MONT SELAS

INDUSTRIAL GAS ENGINEERS

UNIT D2, BROOKSIDE BUSINESS PARK, GREENGATE, CHADDERTON, M24 1GS, ENGLAND

TELEPHONE : 0161-654 7700 FAX : 0161-655 3812

E-MAIL : SALES@MONTSELAS.CO.UK WWW.MONTSELAS.CO.UK

TYPE 341 "WINGTIP" AIR BLAST NOZZLES

- Specifically designed for air blast applications.
- Excellent flame stability.
- Wide range of capacities.
- Suitable for all gaseous fuels.
- Good turndown ratio.



APPLICATIONS

The type 341 Wingtip Burner is designed to operate at or near stoichiometric mixture ratio and provides an intense flame. Typical applications include pre-heating, gap firing of kilns, air heaters and industrial washing machines. The smaller sizes are eminently suitable for use as pilot burners and lighting torches.

SPECIFICATION

Wingtips are precision machined from 18/8 stainless steel as standard. For special high temperature applications alternative materials can be supplied.

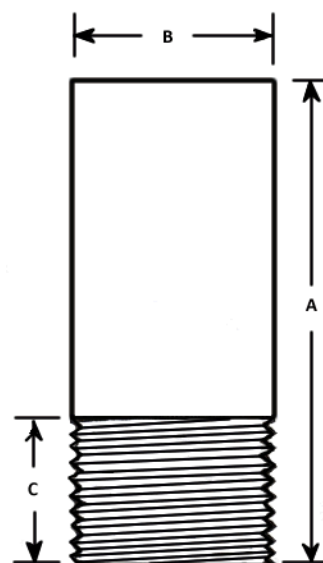

| Type No. | DIMENSIONS | | | | | | | Ratings at 17.4mb (7"wg) mixture pressure | |
|-------------|------------|-----|---------|----|---------|----|-------|--|---------|
| | B.S.P. | A | | B | | C | | | |
| | ins | mm | ins | mm | ins | mm | ins | KW/ | BTU/H/ |
| 341/1 | 3/8 | 54 | 2.1/8 | 17 | 11/16 | 13 | 1/2 | 5.5 | 19,000 |
| 341/2 | 1/2 | 51 | 2 | 21 | 13/16 | 16 | 5/8 | 8.2 | 28,000 |
| 341/3 | 3/4 | 67 | 2.5/8 | 27 | 1.1/16 | 19 | 3/4 | 16.5 | 56,500 |
| 341/4 | 1 | 81 | 3.3/16 | 33 | 1.5/16 | 22 | 7/8 | 27.2 | 93,000 |
| 341/5 | 1.1/4 | 100 | 3.15/16 | 43 | 1.11/16 | 25 | 1 | 47.8 | 163,000 |
| 341/6 | 1.1/2 | 114 | 4.1/2 | 48 | 1.7/8 | 25 | 1 | 57.4 | 196,000 |
| 341/7 | 2 | 152 | 6 | 60 | 2.3/8 | 29 | 1.1/8 | 109.2 | 373,000 |

| Mixture Pressure | 4 | 5 | 6 | 8 | 9 | 10 | 11 | 12 | 13 | 14 |
|------------------|-------|-------|-------|------|------|------|------|------|------|------|
| Multiplier | 0.755 | 0.845 | 0.925 | 1.07 | 1.13 | 1.19 | 1.25 | 1.31 | 1.36 | 1.41 |